

**NOTES:-**

1. Dimensions are in inches.
2. Metric equivalents are given for general information only.
3. Tolerance on height of pad shall be  $\pm 0.015$  (0.38 mm).
4. Unless otherwise specified, tolerances are  $\pm 0.010$  (0.25 mm) for decimals and  $\pm 1^\circ$  on angles.
5. 0.010 (0.25 mm) radius is permissible on corners and edges.
6.  $1^\circ$  draft is permitted on sides

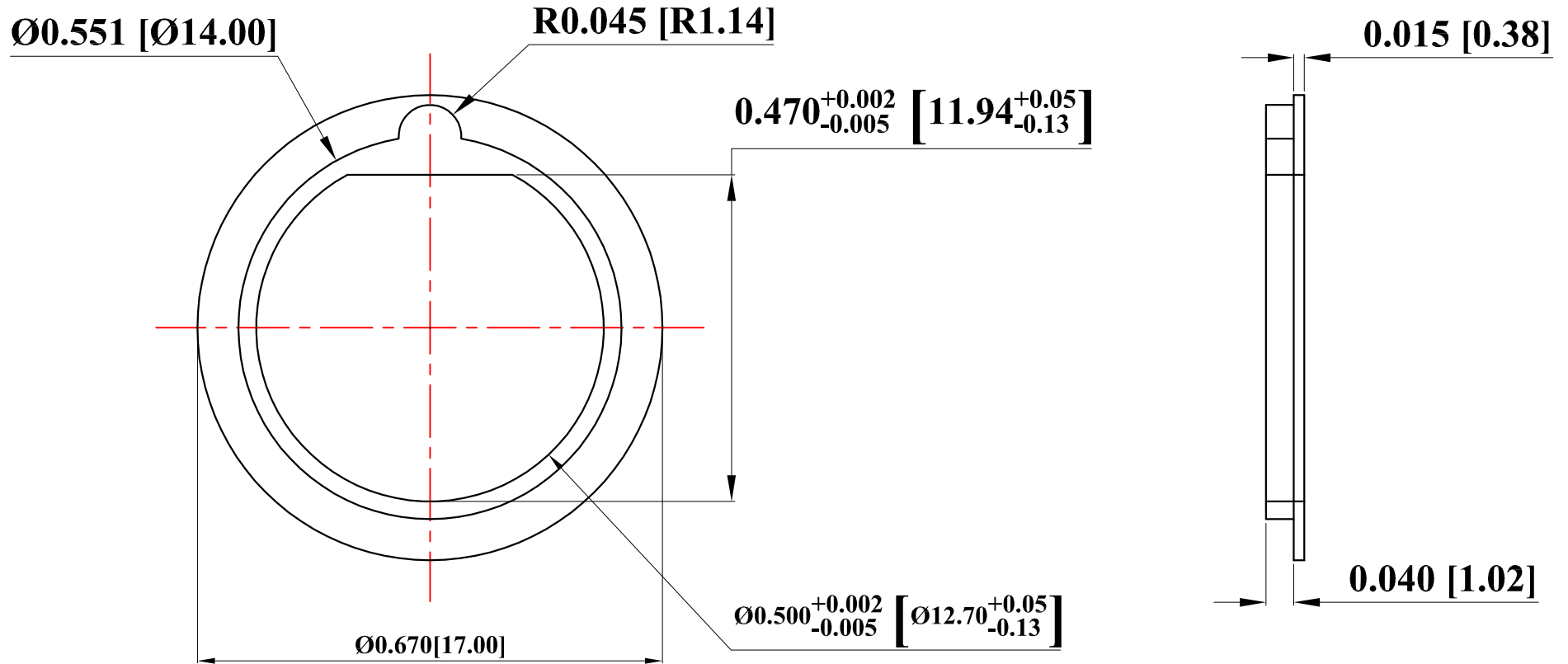

NYLON (N)	10315N	MIL-P-20693, (ASTM D-4066)	NATURAL
DIALYL PHTHALATE (DAP)	10315D	MIL-M-14F-Type SDG, (ASTM D5948-05)	BLACK
<b>MATERIAL</b>	<b>MDP P/N</b>	<b>REFERENCE DOCUMENT</b>	<b>COLOR</b>

REVISIONS

UNLESS OTHERWISE NOTED  
TOLERANCES AFTER MOLDING

FRACTION	DECIMAL	ANGULAR
$\pm 1/64$	X $\pm 0.030$ XX $\pm 0.020$ XXX $\pm 0.010$	$\pm 1^\circ$

NOT TO BE SCALED

**CONNECTORS CABLES SPECIALISTS LTD**

TEL 01279 639251

sales@ccsukltd.co.uk

**MOUNTING PAD**

**DRAWING No.**  
10315

**SHEET No.**  
**1 OF 1**